

SEAL



PROJECT
Village at Bloomfield

CLIENT
REDICO
One Towne Square,
Suite 1600
Southfield, MI 48076

Contact:
Phone: (248) 784-6486

PROJECT LOCATION
Part of the W. 1/2 of Section 5, T. 2N.,
R. 10E., and part of the NE 1/4 of
Section 6, T. 2N., R. 10E., Bloomfield
Township, The City of Pontiac and
Bloomfield Township (conditionally
transferred to The City of Pontiac)
Oakland County, Michigan

SHEET
Menard's Landscape Plan



DATE ISSUED / REVISED
05/12/17 BIDS AND PERMITS

DRAWN BY:

G. Ostrowski

DESIGNED BY:

G. Ostrowski

APPROVED BY:

G. Ostrowski

DATE:

12-19-16

SCALE: 1" = 40'

40 20 0 20 40 60

NFE JOB NO.
A116-21

SHEET NO.
L3

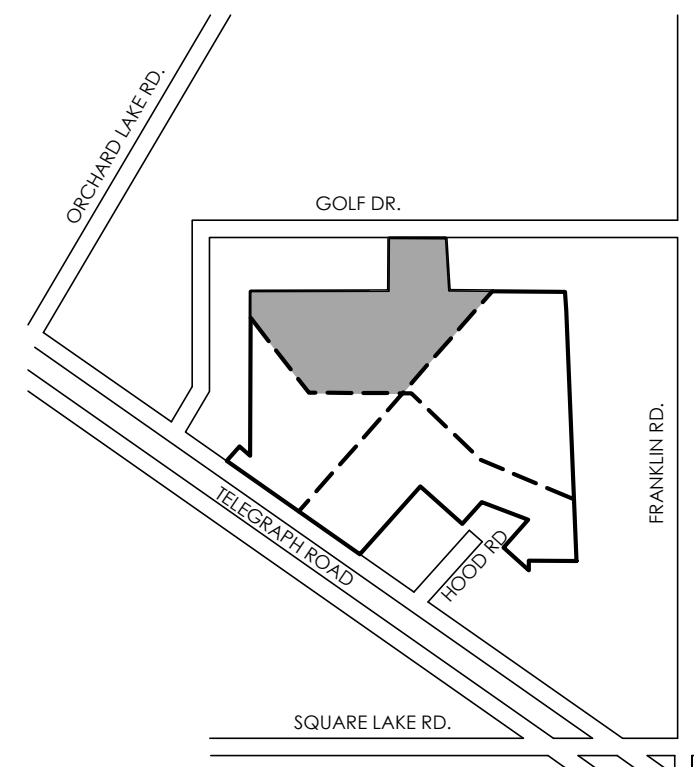
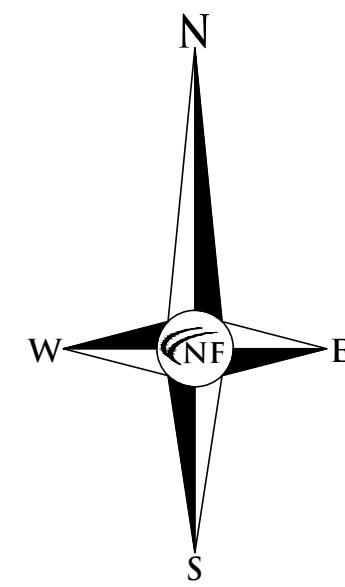

LOCATION MAP
N.T.S.

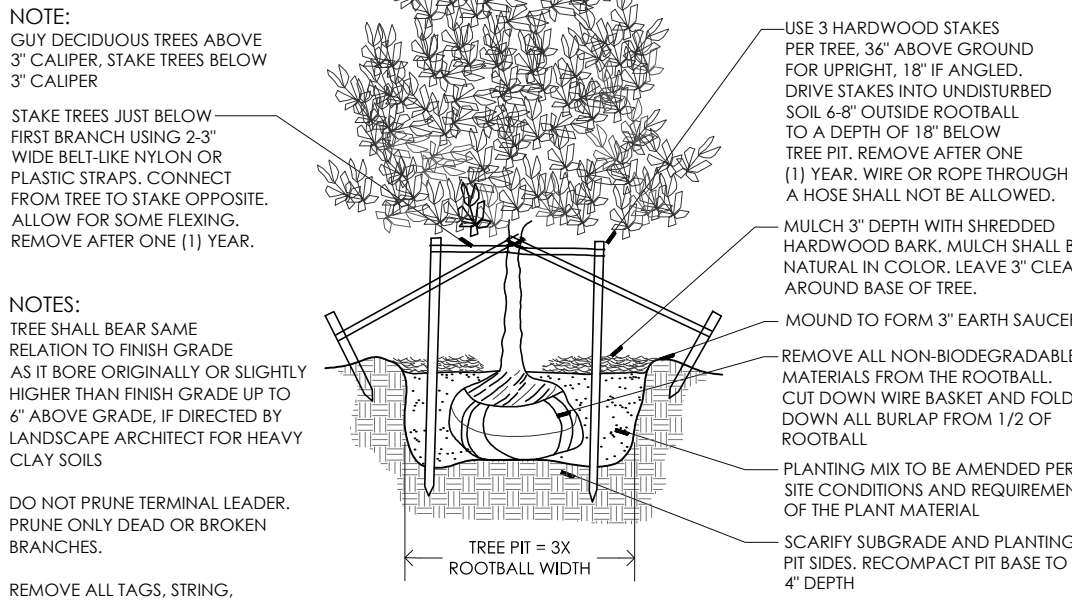

DECIDUOUS TREE PLANTING DETAIL
N.T.S.

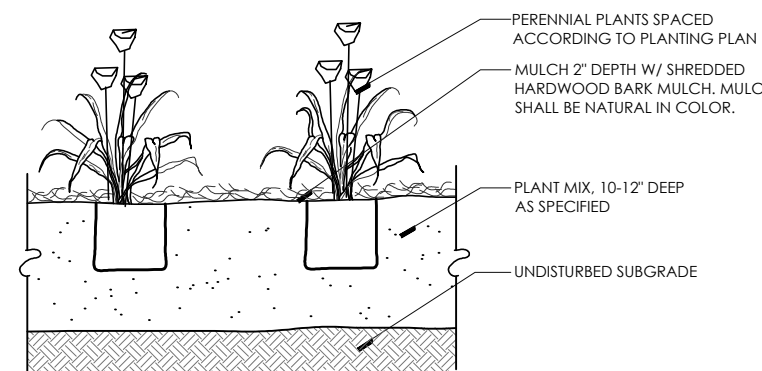

PERENNIAL PLANTING DETAIL
N.T.S.

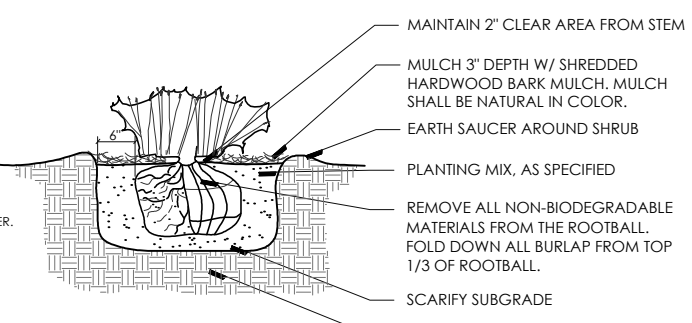

HEDGE PLANTING DETAIL
N.T.S.

GENERAL IRRIGATION NOTE:

ALL LANDSCAPE AREAS SHALL BE IRRIGATED WITH AN AUTOMATIC
UNDERGROUND IRRIGATION SYSTEM. SYSTEM SHALL BE DESIGNED
AS A PART OF CONSTRUCTION PLAN DEVELOPMENT. SEPARATING
LAWN AREAS AND PLANTING BEDS INTO DISTINCT ZONES. THIS INCLUDES ALL
PARKING LOT ISLANDS.

GROUND COVER KEY

- 1 TYPICAL SOD LAWN AREAS, SOWN ON 3" TOPSOIL
- 2 RESTORE EXISTING LAWN AREAS W/ HYDROSEED AND MULCH
- 3 4" DIA/4" WD SPADE CUT EDGE W/ 3" SHREDDED BARK MULCH
- 4 3" DEPTH DOUBLE SHREDDED HARDWOOD BARK MULCH
- 5 2-3" DIA STONE MULCH, 4-6" DEPTH ON WEED BARRIER

PLANT SCHEDULE - THIS SHEET ONLY

KEY	QTY	BOTANICAL/COMMON NAME	SIZE	SPACING	ROOT	COMMENT
TREES						
CL	17	Crataegus laevigata 'Crimson Cloud'	2.5" CAL	SEE PLAN	B&B	FULLY BRANCHED HEADS
GB	18	Ginkgo biloba 'Princeton Sentry'	2.5" CAL	SEE PLAN	B&B	FULLY BRANCHED HEADS
GT	16	Gleditsia triacanthos 'Skyline'	2.5" CAL	SEE PLAN	B&B	FULLY BRANCHED HEADS
MP	7	Morus 'Princeton'	2.5" CAL	SEE PLAN	B&B	FULLY BRANCHED HEADS
MS	13	Morus 'Spring Snow'	2.5" CAL	SEE PLAN	B&B	FULLY BRANCHED HEADS
SHRUBS						
RA	141	Ribes alpinum 'Green Mound'	36" HT	30" OC	B&B	MAINTAIN AS HEDGE
SB	96	Spiraea x b. 'Anthony Waterer'	24" HT	30" OC	B&B	MAINTAIN AS HEDGE
TE	68	Toxus x m. 'Everlow'	18" HT	24" OC	B&B	MAINTAIN AS HEDGE
GROUND COVERS/PERENNIALS						
CA	7	Calamagrostis a. 'Karl Foerster'	3 GAL	30" OC	CONT	
HR	110	Hemerocallis 'Happy Returns'	2 GAL	18" OC	CONT	

SEE SHEET L1 FOR OVERALL PLANT TOTALS

MENARD'S DEVELOPMENT
LANDSCAPE REQUIREMENTS

EXISTING SITE AREA: 686,272.23 S.F. OR 15.75 ACRES

GENERAL SITE LANDSCAPE
5% OF TOTAL SITE AREA SHALL BE LANDSCAPED
686,272.23 S.F. X 5% = 34,313.61 S.F. REQUIRED
PROVIDED: 71,340.26 S.F.

PARKING ABUTTING A R.O.W.
1 TREE PER 30 L.F. PLUS HEDGE
REQUIRED:
NORTH OF DRIVE: 372.47 L.F. OF FRONTAGE / 30 L.F. = 12.4 OR 13 TREES REQUIRED
PROVIDED: 15 TREES, A WAIVER WILL BE SOUGHT FOR THE HEDGE REQUIREMENT
SOUTH OF DRIVE: 165.62 L.F. OF FRONTAGE / 30 L.F. = 5.57 OR 6 TREES REQUIRED
PROVIDED: 6 TREES, A WAIVER WILL BE SOUGHT FOR THE HEDGE REQUIREMENT

PARKING LOT LANDSCAPE REQUIREMENTS
1 TREE FOR EACH 6 PARKING SPACES
REQUIRED: 416 PKG SPACES / 6 = 69.33 OR 70 TREES
PROVIDED: 72 TREES

